

Hector — Assembly Guide

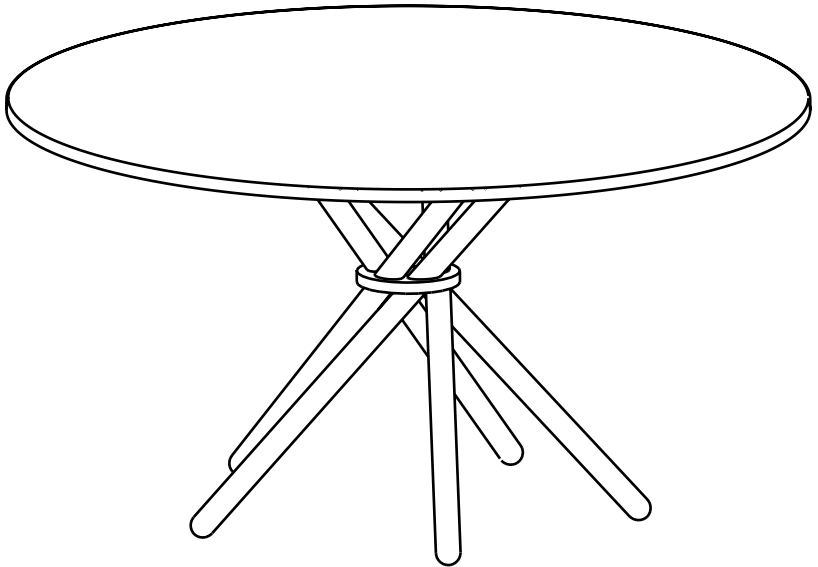

Assembly Guide Video

On our website you will find guidelines to help you make sure that your furniture is assembled correctly. Access our assembly guides with ease using the camera on your smartphone to scan the QR code on the left.

Hector — Assembly Guide

Before we get started:

- We recommend that you leave the table in its original packaging at room temperature for 24 hours after receiving the table. This is to acclimate.
- Make sure that all parts are included in the packaging.
- Protect the table from scratches by assembling it on the cardboard box itself or use a large blanket/carpet.
- We do not recommend assembling the table alone, you should be a minimum of two people.

- A. Hector table top (1)
B. Hector table legs (5)
C. Protective washers (5)
D. Hector assembly ring (1)

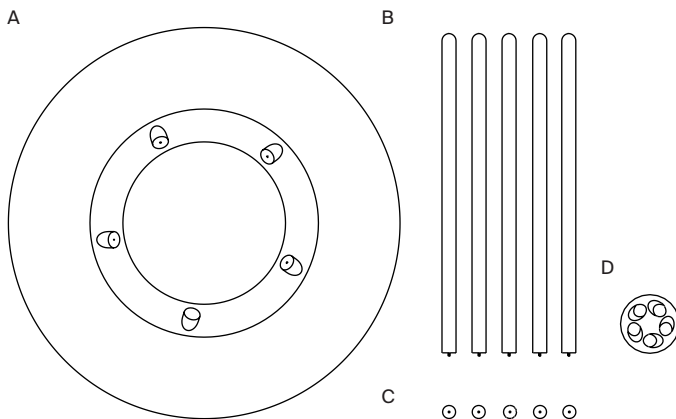

Step 1 —

With your Hector table top (A) turned upside-down on a soft surface, begin by mounting one Hector table leg (B), and make sure that there is a protective washer (C) placed in between the table leg and table top bracket.

Do not tighten leg completely.

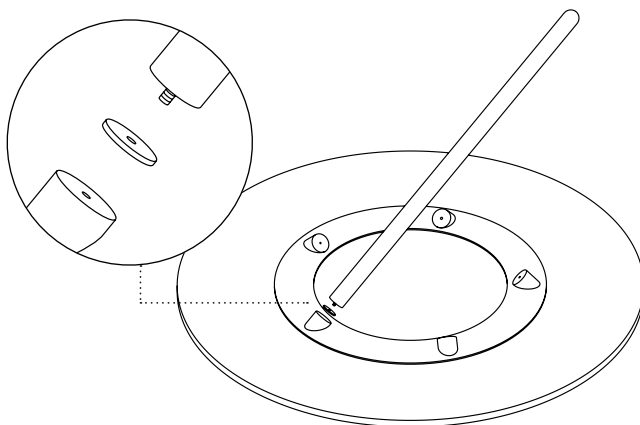

Step 2 –

Place your Hector assembly ring (D) on the table leg, lowering to a center position.

- Make sure the assembly ring is leveled even horizontally.
- The small hole on the assembly ring should be facing the floor when the table is in place.

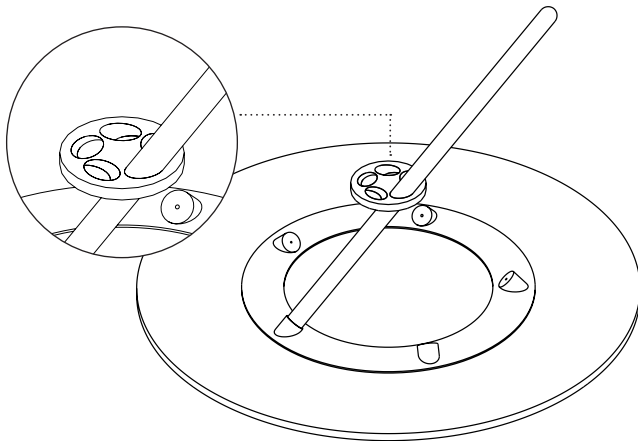

Step 3 –

Through the holes in the assembly ring, gently mount the remaining 4 Hector table legs (B) and do not tighten completely, until all 5 legs are mounted.

- When all table legs are mounted, make sure the assembly ring is horizontally level placed at center position.
- Tighten the table legs completely.

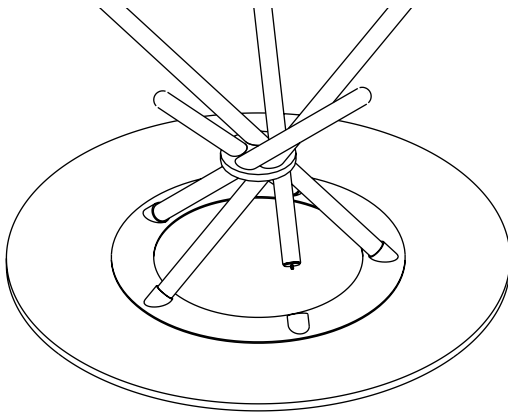

Step 4 –

Gently lift your Hector dining table and flip it over to its natural position.

Congratulations, your new Hector dining table is now ready for use.

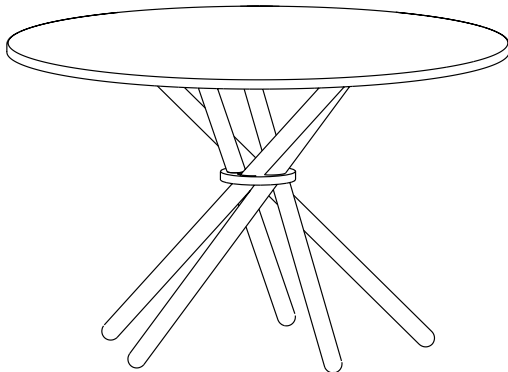

Maintenance & Care – Information

Maintenance and care on a regular basis can prolong the life of your furniture, and make sure it will last through ages. Here, we have gathered a short introduction to inform you about the most important things to know. We highly recommend you visit the maintenance section on our website for extended maintenance information.

Concrete –

- Concrete tabletops are pre-treated with a liquid and silicone-free wax from production. If you want a raw and more variegated tabletop, we recommend using the table without further treatment. If you want a more well-protected top against everyday dirt, we recommend that you regularly treat the table with the same liquid wax that we have given the table from its birth.
- Avoid direct sunlight on the furniture the first 4 weeks.
- Wipe with a clean, damp cloth. We recommend cleaning without detergent.

Wood –

- All wooden parts are made of solid oak. Wood is a natural material, which can be affected by changing humidity, heat, direct sunlight and normal wear and tear.
- For daily care use a damp cloth without detergents or washing liquid or use cleaning products specifically designed for solid wood.
- We recommend oil treatment of the furniture 4-6 times in the first year, and afterwards minimum twice a year, preferably before and after the winter period.

Linoleum –

- To prevent stubborn stains, trivets should be used under flower pots, vases and preferably also under cups and glasses etc. It is important to remove stains immediately to prevent permanent marks.
- For ongoing maintenance of the surface use a linoleum care product. In case of heavy soiling use a suitable neutral detergent (eg Forbo Cleaner).
- Small scratches can be made less visible with massaging your finger or a fat nut (eg walnut) against the scratch.



Extended Maintenance Information

On our website you will find extended information on maintenance of our products, along with tips and tricks to help you take good care of your furniture. Use the camera on your smartphone to scan the QR code on the left to visit our maintenance page.